

- Nozzles and Pipes -

Always cut pipes with a rotary pipe cutter and deburr the inside of the tube this will prepare the pipe for fitting to the connectors which are all push in. Ensure all push in fittings are fully inserted into the fitting.

Your system is supplied with 6 nozzles, A minimum of 2 must be fitted in the cockpit. A minimum of 3 should be fitted to the engine bay, **ALL 6 NOZZLES MUST BE USED**. It is recommended that a vehicle with a turbocharger, 4 nozzles are fitted to the engine bay 2 on the inlet system and 2 on the Turbocharger plus 2 in the cockpit. On normally aspirated engines 3 in the cockpit and 3 in the engine bay.

- Maintenance -

Ensure the pressure gauge is in the green. Visual inspection of all components for damage, including nozzles tubes and cylinder, ensure cables are well lubricated with grease.

Every 2 years the system must be returned to PDE or one of its approved service agents for service and revalidation. As this system has a stainless-steel cylinder, this system has a 16 year safe working life.

- Replacement Pipe , Fittings and Nozzles -

All pipes and fittings are available from PD Extinguishers or its authorised agents.



PD Extinguishers
Revidge Fold
Revidge Road
Blackburn
BB1 8DJ
+44 (0)254 954954

info@pdextinguishers.co.uk
www.pdextinguishers.co.uk

Revision 2



4kg Haylo (Halon replacement) Fire Extinguishing System

Mechanical Operation

Installation & Maintenance Instructions



Thank you for purchasing a PD Extinguishers System, this extinguisher is designed to suppress fire in a competition saloon car, giving the occupants of the car time to exit the vehicle to safety. This system complies with its FIA Homologation only when installed in its entirety.

- System Components-

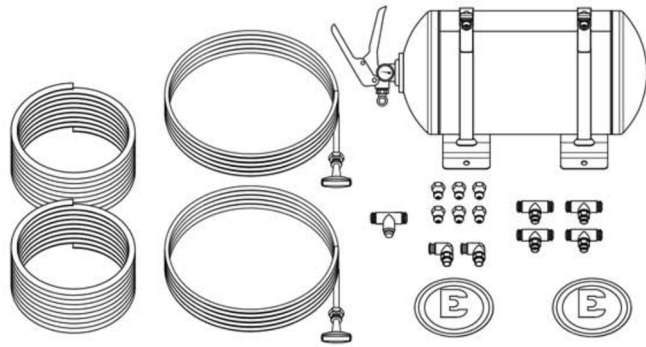

1 x Cylinder with Valve	2 x Rolls of Pipe
6 x Nozzles	6 x Lock Nuts and Washers
2 x Bracket including Straps	4 x Tee Nozzle Fittings
2 x Pull Cables	2 x Cable Nipples
2 x 90° Nozzle Fittings	1 Tee Pipe Fitting
2 x E Stickers	1 x Instruction Manual
8 x M6 Bolts Nuts and Washers	1 x Bulkhead Fitting

-Extinguishant and Ingredients -

Information on Toxicological effects Signs and Symptoms of Exposure. Based on test data and/or information on the components, this material may produce the following health effects:

Inhalation: No known health effects.

Skin Contact: Contact with the skin during product use is not expected to result in significant irritation.

Eye Contact: Contact with the eyes during product use is not expected to result in significant irritation.

Ingestion: No known health effects.

Toxicological Data

Acute Toxicity

Name Route Species Value

1,1,1,2,2,4,5,5,5-Nonafluoro-4-(trifluoromethyl)-3-pentanone Dermal Professional judgement LD50 estimated to be > 5,000 mg/kg

1,1,1,2,2,4,5,5,5-Nonafluoro-4-(trifluoromethyl)-3-pentanone Ingestion Professional LD50 estimated to be > 5,000 mg/kg

- Mechanical Cable Actuation -

Pull Cables should be mounted to prevent tight bends or kinking of cables. Drill a 12mm hole in the panel where the cable is to be mounted, take care to ensure the panel is sufficiently strong to prevent panel deforming, place reinforcement behind if required. 1, to be mounted externally below the windscreen 2, to be mounted internally in easy reach of both occupants (if applicable) Please lubricate cables with grease and check regularly for free operation. Fit the cable to the valve as indicated in Figure 1, allow 6 to 12mm clearance to the nipple. Fit the Stickers adjacent to the Pull to identify the location.

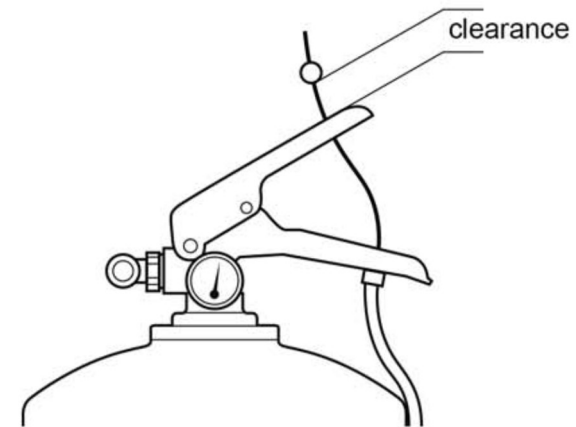

Fig 1